

FILTER

- Erebus Filter
 - OTA based circuit
 - 2-pole, 12db / oct
- Low Pass and High Pass outputs
- Voltage Controlled Resonance
 - Accepts inputs up to 10Vpp
- Current Draw: 22mA (at +12V)
20mA (at -12V)
8HP

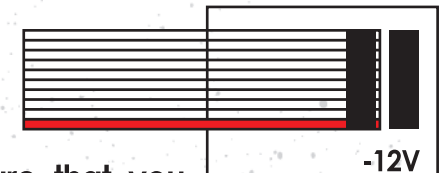
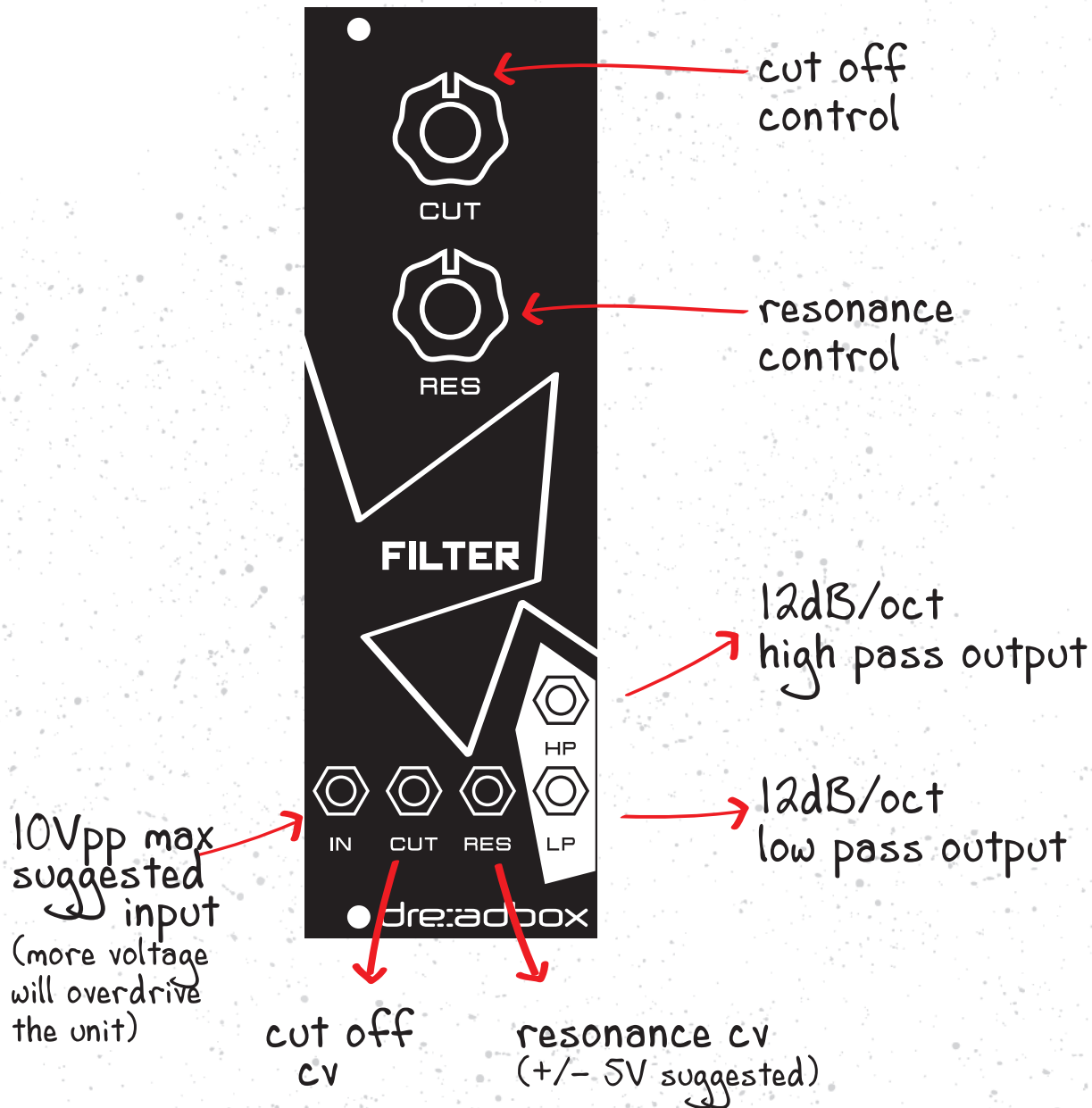

Make sure that you connect the module to the power in the right way.

The red stripe of the ribbon indicates -12V



dre:adbox